



VIBRATION
ROLLER

Vibration Roller 25

Safety Operation

Deadman Brake

The deadman brake prevents accidents when backing up the machine. (Emergency stop device)



Deadman brake

Head Light and Rubber Bumper

The convenient Head Light suited nighttime work is equipped as standard. The Rubber Bumper is equipped as standard to protect the machine from the impact of frontal collisions. (MRH-501•601•700)



Self-start safety design

Engine self-start is a safety feature that is designed to prevent the engine from starting if the travel lever is not in the neutral position.

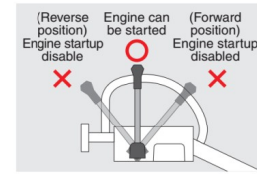

Soft Start

Prevent Drum-mark against surface of paving Asphalt.



Safety Transportation

To transfer safety by a truck

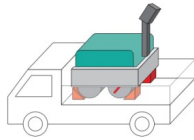

To prevent slide off, be sure to use **parking stopper** and **handbrake**. (MRH-501•601•700)



Parking drum stopper



Parking brake

Slope runaway preventer



A device that engages when parked on a slope. (When the engine is stopped), always be sure to park the roller on a flat area.

Periodically Maintenance

Hour Meter is equipped as standard.

Hour meter is equipped as standard. It lets you check work and maintenance time. (MRH-501DS•601DS•700DSCB•900DS)

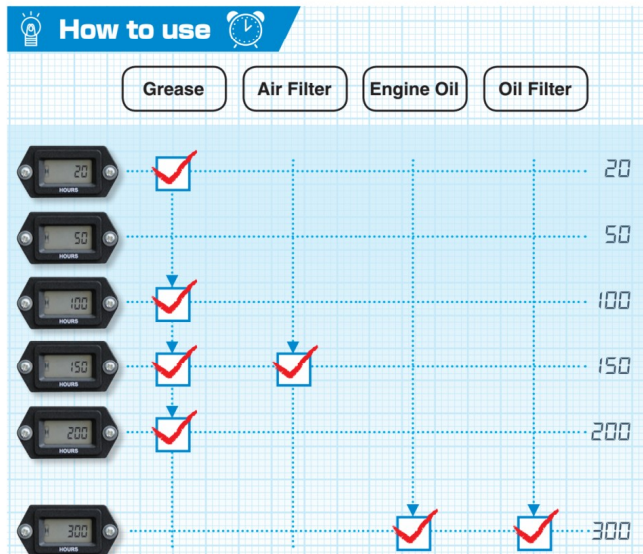

Hydraulic Pipe Guard

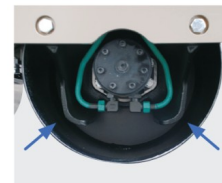

One-Touch-Open Center Cover

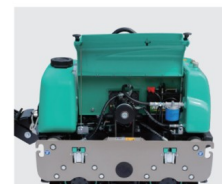

Saving your time

Work efficiency



2,000m²/hour



500m²/hour

Compaction Area/Hour

MODEL	Width		Speed		Compaction area/hour m ²
	mm	m(A)	m/min	m	
① MVC-F60	350	0.350	25	1500	525.0
② MRH-601DS	650	0.650	50	3000	1950.0
MRH-700DS					
MRH-900DS					

- ① 0.350m (A) x 25m/min. x 60min/hour = 525m²/hour
 ② 0.650m (A) x 50m/min. x 60min/hour = 1,950m²/hour

Designed with for superb visibility

Its low-center of gravity design lets you see easily in front of the roller ensuring you a wide field of vision.



Excellent side clearance

The extremely small clearance between the drum and frame makes aligning easy.



Safety Design for not only up hill but Down hill

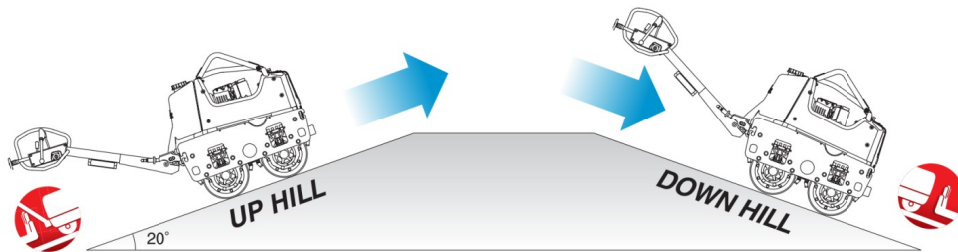

Engine Guard

The side of body flattened by Engine guard as standard equipment lets you work comfortably alongside walls and curbs.

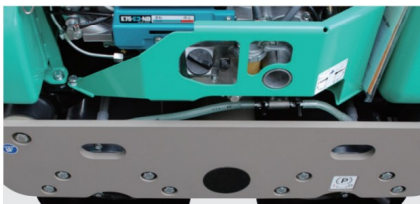

A compact design that requires less space for storage

You can stow the handle upright and leaves more space on the truck bed.

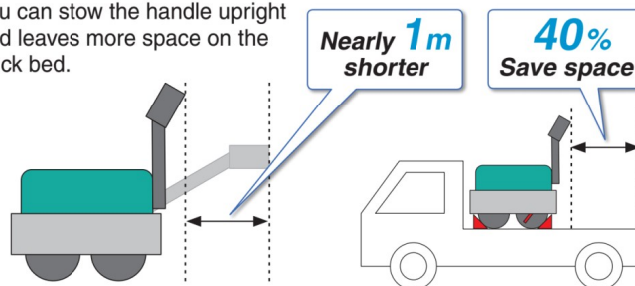

Vibration Roller

- Mikasa's original strainer and plastic water tank prevents the sprinkler pipes from clogging.
- Dust-proof and Water-proof have been improved and the Durability has increased.
- The Rubber Bumper is equipped as standard to absorb the impact from frontal collisions lessening the damage to the machine.

MRH-601DS (551kg)

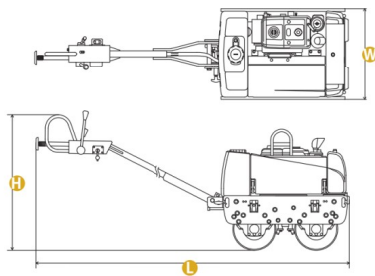

● One-Touch Center Cover



● Head Light, Rubber Bumper

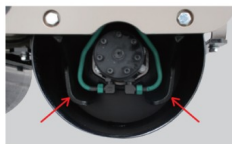

● Hydraulic Pipe Guard



● Engine Guard



● Parking Brake



● Parking Drum Stopper



● Deadman Brake



● Buzzer and Light Switch



● Vibration Switch



● Maintenance Hour Meter

MRH Specifications

model	weight (kg)	dimensions (mm)	drum size (mm)	vibrating frequency Hz (V.P.M.)	centrifugal force kN (kgf)	traveling speed (km/h)	max.limited gradeability (%)	water tank (lits)	power source kW (PS)
MRH-601DS (water cooled)	551	H : 1,195 W : 692 L : 2,265	dia : 355 width : 650	55 (3,300)	10.8 (1,100)	0-3	35	30	Kubota EA330 diesel (electric start) max. output 4.6 (6.3)

MRH-501DS (530kg)

MRH-700DSCB (700kg)

● Recoil Start is available.
(MRH-700DSCB/700GS)

MRH-700DSB (728kg)

MRH-700GS (680kg)

MRH Specifications

model	weight (kg)	dimensions (mm)	drum size (mm)	vibrating frequency Hz (V.P.M.)	centrifugal force kN (kgf)	traveling speed (km/h)	max.limited gradeability (%)	water tank (lits)	power source kW (PS)
MRH-501DS (water cooled)	530	H : 1,195 W : 617 L : 2,265	dia : 355 width : 575	55 (3,300)	10.0 (1,020)	0-3	35	30	Kubota EA330 diesel (electric start) max. output 4.6 (6.3)
MRH-700DSB (water cooled)	728	H : 1,170 W : 692 L : 2,670	dia : 406 width : 650		23.5 (2,400)				Yanmar TF70V diesel (electric start) max. output 5.5 (7.5)
MRH-700DSCB (air cooled)	700				Yanmar L100N diesel (electric start) max. output 5.5 (7.5)				
MRH-700GS	680				Honda GX390 gasoline (electric start) max. output 8.7 (11.8)				

Vibration Roller

- High Durability for Hydraulic Motor against Dust.
- Tacho Hour Meter as Standard Equipment.
- Strong Side Cover to Protect Machine Body from Impact.

MRH-900DS (870kg)

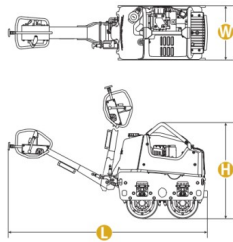

● Key Start System



● Front Guard Bumper



● Two-Stage Cyclone Filter



● Auto Parking Brake System

● Water Tank 60L

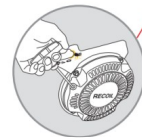

● Recoil Start is available.



● Tacho Hour Meter with Battery checker TP-33DA



● Deadman Brake



● ON/OFF Lever for Vibration of Mechanical Clutch System



● Manual Storage Box

MRH Specifications

model	weight (kg)	dimensions (mm)	drum size (mm)	vibrating frequency Hz (V.P.M.)	centrifugal force kN	traveling speed (km/h)	max.limited gradeability (%)	water tank (lits)	power source kW (PS)
MRH-900DSY (air cooled)	870	H : 1,255 W : 704 L : 2,600	dia : 406 width : 650	55 (3,300)	16.8 (1,700)	0-3	35	60	Yanmar L100N diesel (electric start) max. output 5.5 (7.5)